

Tax Parcel
QVD 00016B

recorded as (East 281.55')
N89°58'32"E 281.64'

Found pipe bent,
dug down 1' until
straight, RESET
pipe in hole.

recorded as (S89°57'00"E 101.33')
S89°57'00"E 101.25'

Pipe set by John
P. Krott on survey
dated 06-12-1998 is
0.56' S5°51'17"W of
pipe set at corner.

recorded as (S89°57'00"E 281.80')
S89°57'00"E 281.57'

12' Utility Easement
As shown on the plat of Bella Vista.

Shed

Garage

Lot 1
Tax Parcel
QB 00035
0.321 Acre
13,980 Sq.Ft.

House
No. 336

David Street
(66' Wide)

Plat of Survey

of

Lot 1 in Block 4 of Bella Vista,

a subdivision located in the Southeast 1/4 and the Southwest 1/4 of the Northwest 1/4 of
Section 27, Town 2 North, Range 15 East, Village of Darien, Walworth County, Wisconsin.

Surveyed for: **Efren & Maria Mendoza**
P.O. Box 234
Darien, Wisconsin. 53114

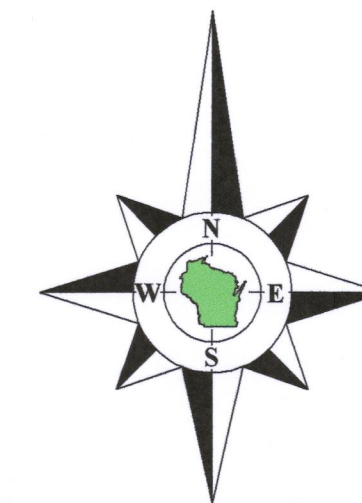

Bearings referenced to the North line of Lot 1 in Block 4 and the North line
of Lot 1 in Block 5, recorded as S89°57'00"E on the plat of Bella Vista which
produces a bearing of N89°59'12"E on the South line of the Northwest 1/4
of Section 27-2-15. A rotation of 2°20'44" from the Wisconsin State Plane
Coordinate System, South Zone, (NAD-27).

Coordinates are referenced to the Wisconsin State
Plane Coordinate System, South Zone, (NAD-27).

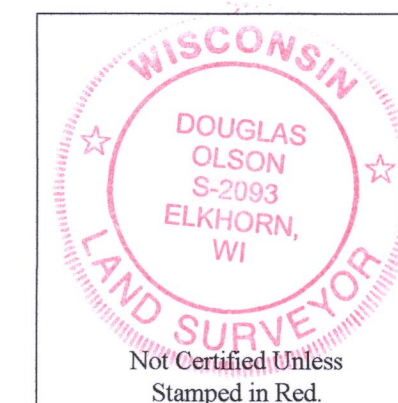

Notes:

- 1) This Plat of Survey is not certified unless signed and sealed in red ink.
- 2) This survey is subject to Wisconsin lien laws. This Plat of Survey is the notice of intent to file lien. Lien waiver required.
- 3) The Survey Date shown on this Plat of Survey is the completion date of the field work.

Copyright ©2018 by Olson Land Surveying, LLC.

All rights reserved. No part of this survey plat may be reproduced or transmitted in any form by any means - graphic, electronic, or mechanical, including photocopying, tracing, or information storage and retrieval systems - without permission in writing from Douglas G. Olson, Olson Land Surveying, LLC.

I hereby certify that I have surveyed the above described property in compliance with Chapter A-E 7 of the Wisconsin Administrative Code and that the map hereon is correct to the best of my professional knowledge and belief and shows the size and location of the property, its exterior boundaries, the location and dimensions of all visible structures thereon, boundary fences, apparent easements and roadways and visible encroachments, if any.

This survey is made for the exclusive use of the present owners of the property, and also those who purchase, mortgage or guarantee title thereto, within one year from the date hereof.

Douglas G. Olson
Wisconsin Professional Land Surveyor - 2093

Survey Date: May 7, 2018.
Revisions:

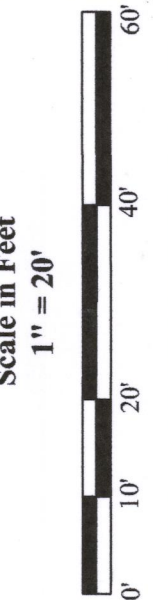

45 South Wisconsin Street | P.O. Box 322
Elkhorn, Wisconsin. 53121
Telephone: (262) 723-3434
Facsimile: (262) 723-8044
Email: doug@olsonsurveying.com
Website: www.olsonsurveying.com

OLSON
LAND SURVEYING, LLC
Rural | Residential | Commercial

Legend of Symbols & Abbreviations
Found Iron Pipe, 2" dia.
Found Iron Pipe, 1" dia.
Set Iron Pipe, 2" dia.
Set Iron Pipe, 1" dia.
Recorded Information
Light Pole
Utility Box or Pedestal
Asphalt Surface
Concrete Surface

Sheet 1 of 1 Sheets
Drawing Name:
Job Reference Number
2018.055

2018.055

QB-35

001-614